

LOWER DOCK STREET TOWNSCAPE HERITAGE INITIATIVE
PREFERRED ARCHITECTURAL DETAILS

Head of Planning and Economic Regeneration

Civic Centre
Newport
South Wales

Telephone 01633 232163



Newport
COUNTY BOROUGH
BWRDEISTREF SIROL
Casnewydd

CONTENTS

SASH WINDOW TYPICAL ELEVATIONS
SASH WINDOW TYPICAL JAMB SECTION
SASH WINDOW TYPICAL HEAD SECTION
SASH WINDOW TYPICAL MEETING RAILS & GLAZING BAR SECTIONS
SASH WINDOW TYPICAL CILL SECTION
SASH WINDOW TYPICAL HORN SECTION
3 PANEL DOOR TYPICAL ELEVATION PLAN & SECTION
3 PANEL DOOR TYPICAL FANLIGHT HEAD SECTION
3 PANEL DOOR TYPICAL TRANSOME SECTION
3 PANEL DOOR TYPICAL TOP RAIL SECTION
3 PANEL DOOR PANEL & MOULDING SECTION
3 PANEL DOOR TYPICAL MID RAIL SECTION
3 PANEL DOOR TYPICAL BOTTOM RAIL SECTION
4 PANEL DOOR TYPICAL ELEVATION PLAN & SECTION
4 PANEL DOOR TYPICAL FANLIGHT HEAD SECTION
4 PANEL DOOR TYPICAL TOP RAIL & TRANSOME SECTION
4 PANEL DOOR TYPICAL DOOR MIDDLE RAIL SECTION
4 PANEL DOOR TYPICAL BOTTOM RAIL SECTION
4 PANEL DOOR TYPICAL JAMB & STILE SECTION
4 PANEL DOOR TYPICAL MUNTIN SECTION
DOLPHIN STREET TYPICAL HOUSE ELEVATION
SOUTH MARKET STREET TYPICAL HOUSE ELEVATION

Head of Planning and Economic Regeneration

Civic Centre
Newport
South Wales

Telephone 01633 232163



Newport
COUNTY BOROUGH
BWRDEISTREF SIROL
Casnewydd

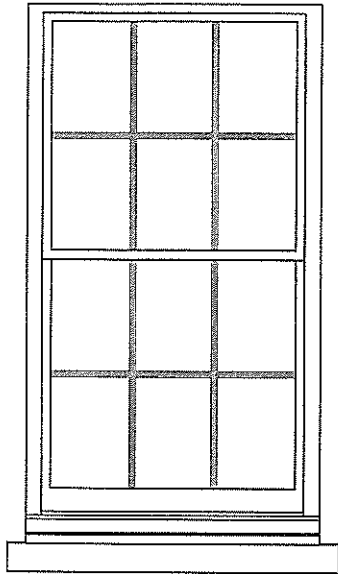

6 OVER 6
NO HORNS

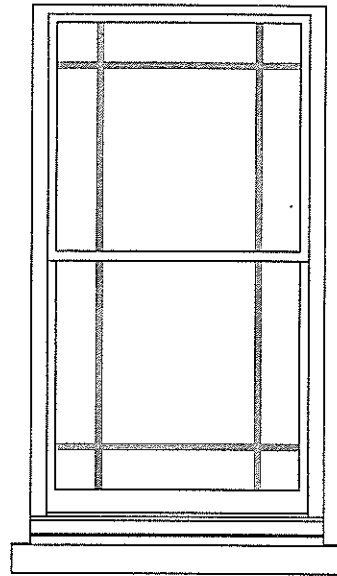

MARGIN LIGHTS
NO HORNS

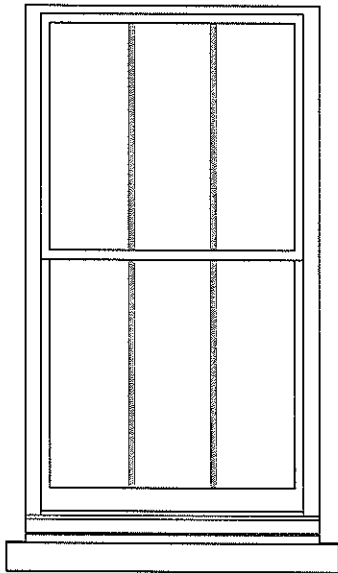

3 OVER 3
NO HORNS

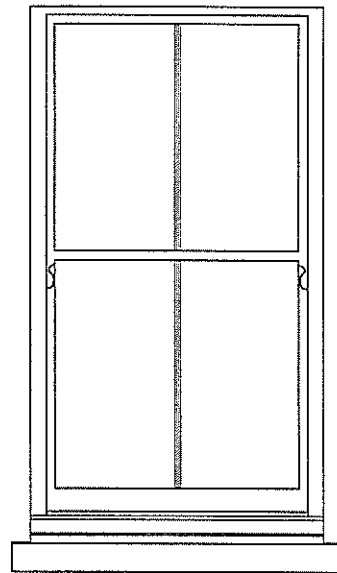

2 OVER 2
WITH HORNS

OVERALL SIZES SHALL MATCH THE ORIGINAL STRUCTURAL OPENINGS.
VERIFY THAT THE STRUCTURAL OPENINGS ARE ORIGINAL BEFORE MANUFACTURE.

SASH WINDOW
TYPICAL ELEVATIONS

1/20 SCALE

Head of Planning and Economic Regeneration

Civic Centre
Newport
South Wales

Telephone 01633 232163



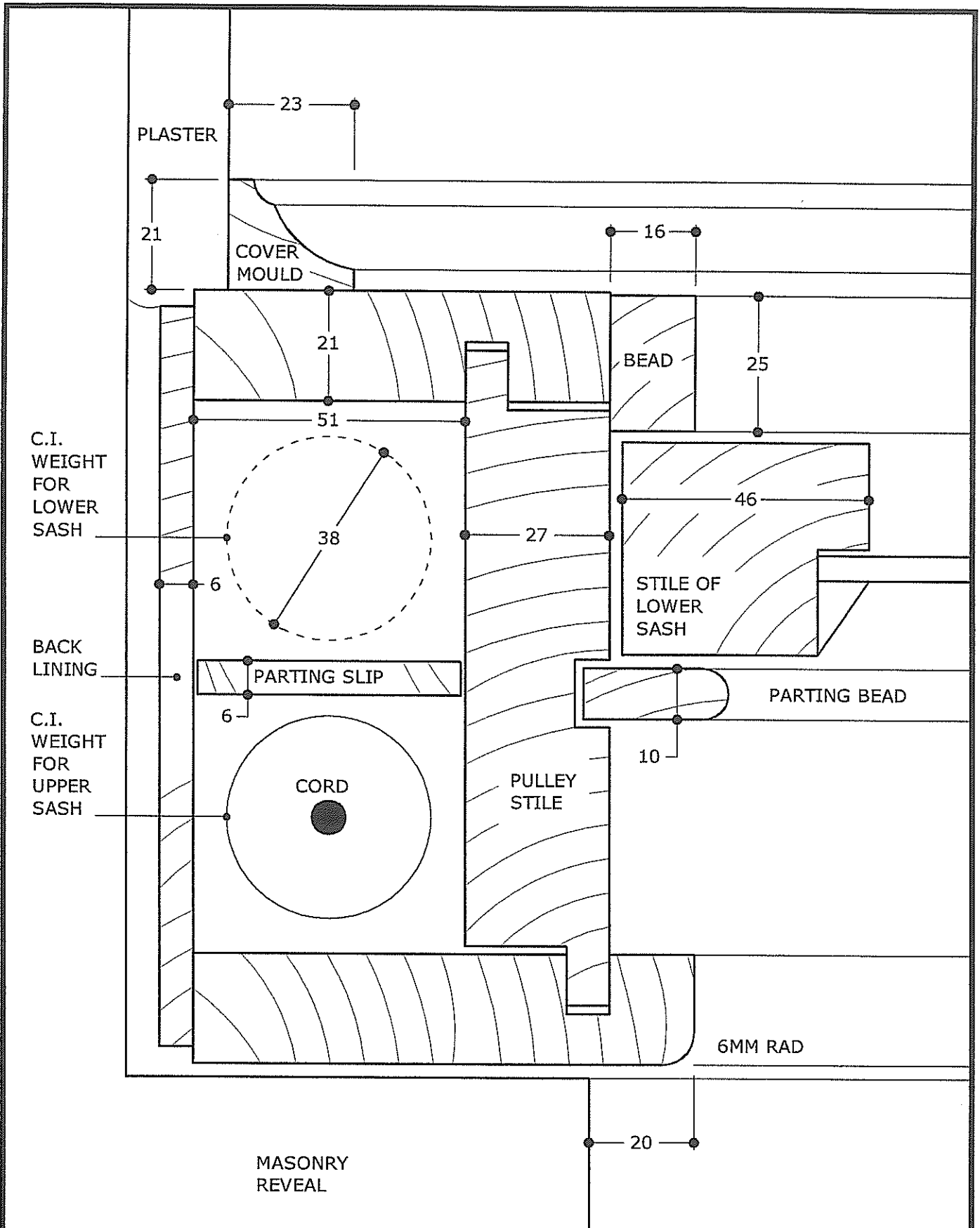

SASH WINDOW
TYPICAL JAMB SECTION

FULL SIZE

Head of Planning and Economic Regeneration

Civic Centre
Newport
South Wales

Telephone 01633 232163



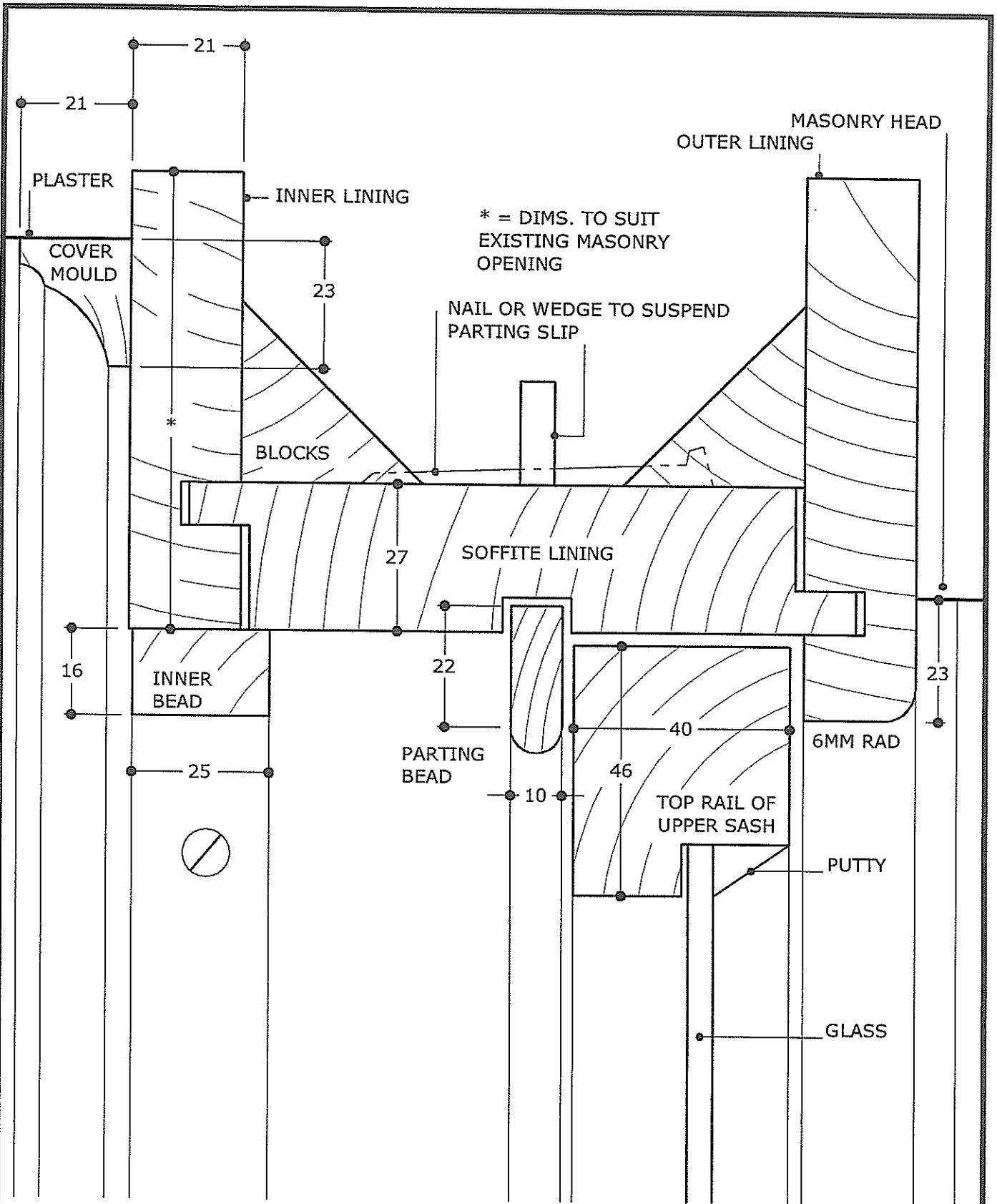

SASH WINDOW
TYPICAL HEAD SECTION

FULL SIZE

Head of Planning and Economic Regeneration

Civic Centre
Newport
South Wales

Telephone 01633 232163



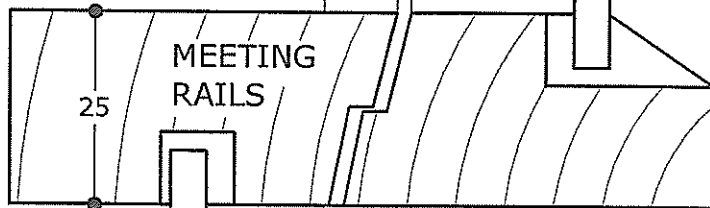

LAMB'S
TONGUE
GLAZING
BAR
MOULDING

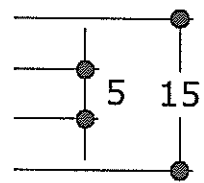
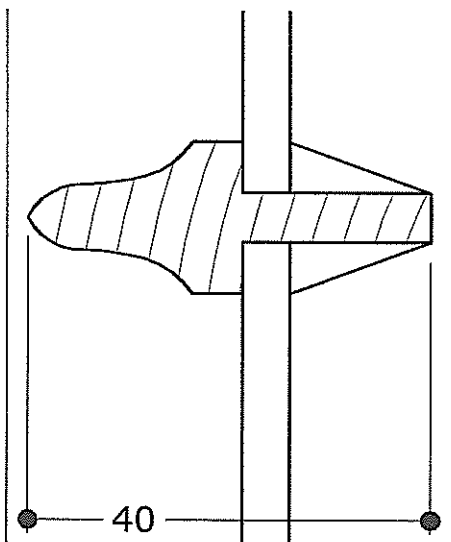

SASH WINDOW
TYPICAL MEETING RAILS
& GLAZING BAR SECTIONS
FULL SIZE

Head of Planning and Economic Regeneration
Civic Centre
Newport
South Wales
Telephone 01633 232163



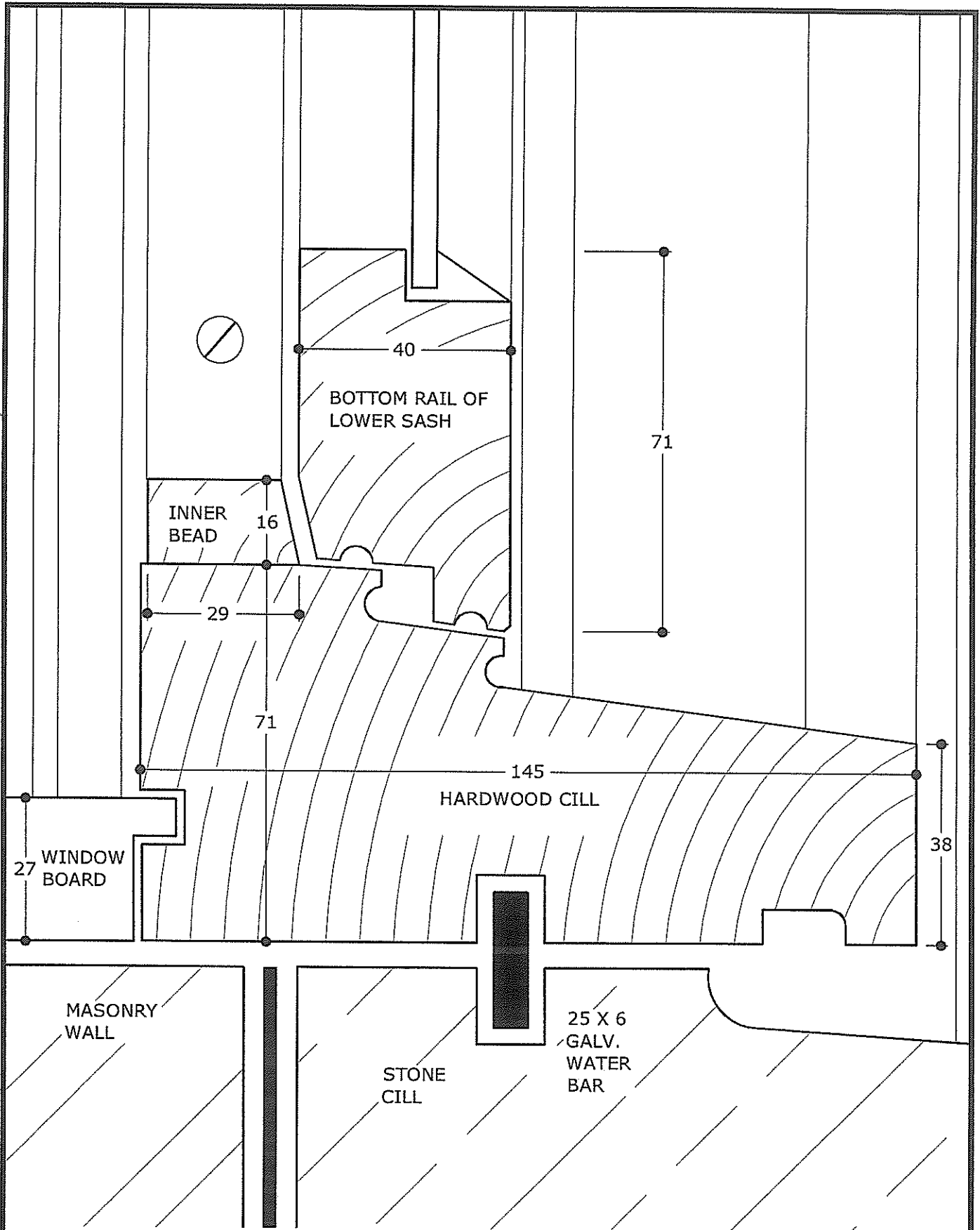

SASH WINDOW
TYPICAL CILL SECTION

FULL SIZE

Head of Planning and Economic Regeneration

Civic Centre
Newport
South Wales

Telephone 01633 232163



Newport
COUNTY BOROUGH
DYMAESTREF SIROL
Casnewydd

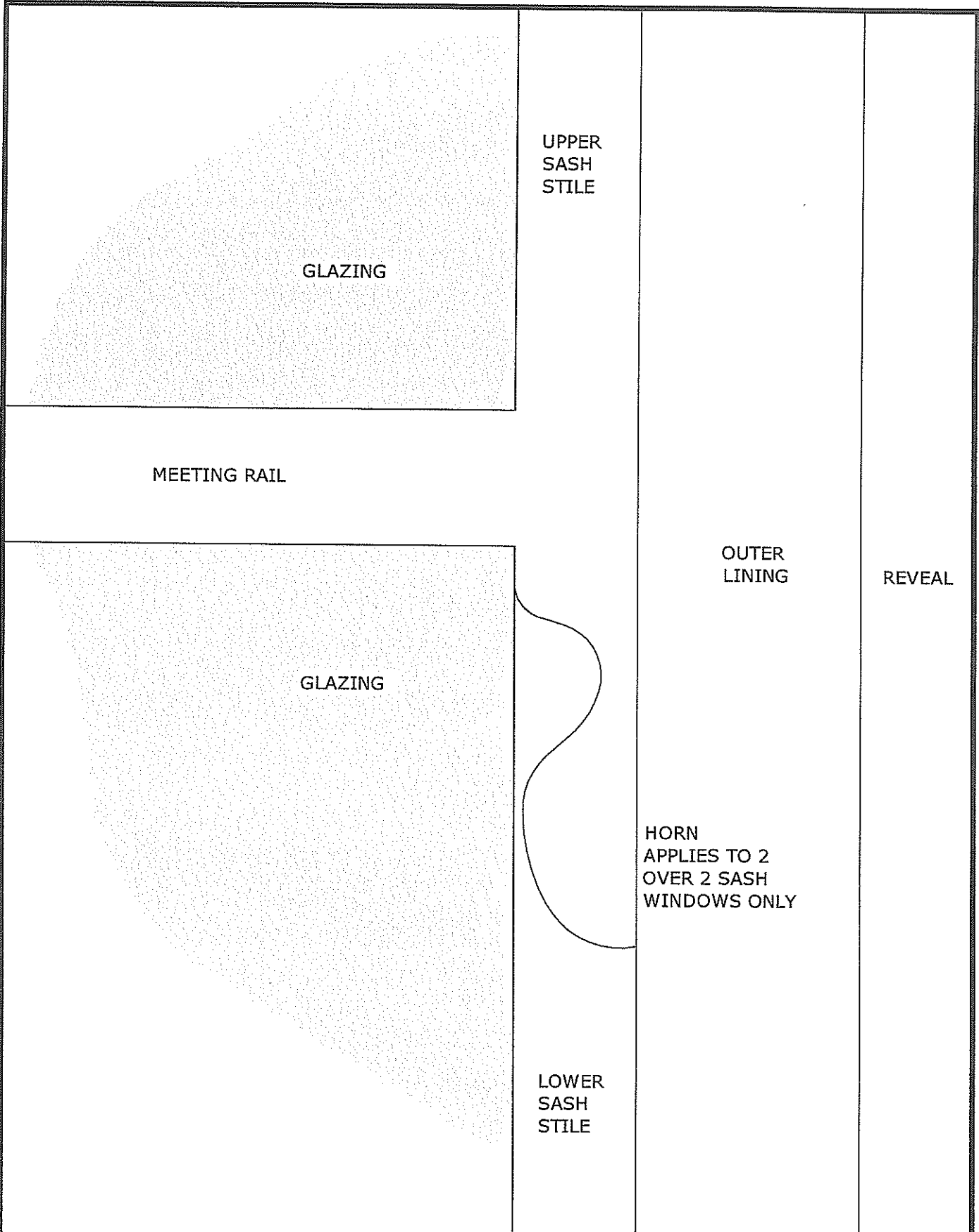

SASH WINDOW
TYPICAL HORN DETAIL

FULL SIZE

Head of Planning and Economic Regeneration

Civic Centre
Newport
South Wales

Telephone 01633 232163



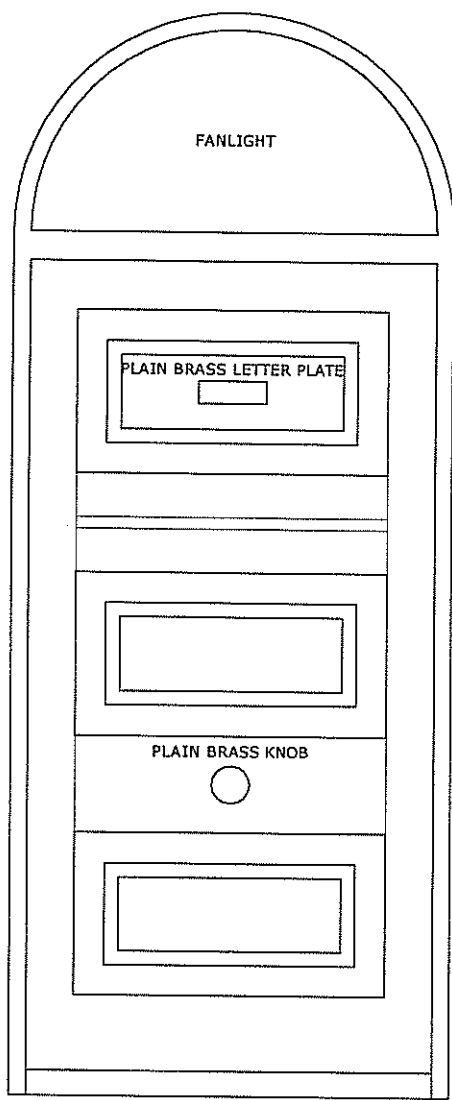

ELEVATION

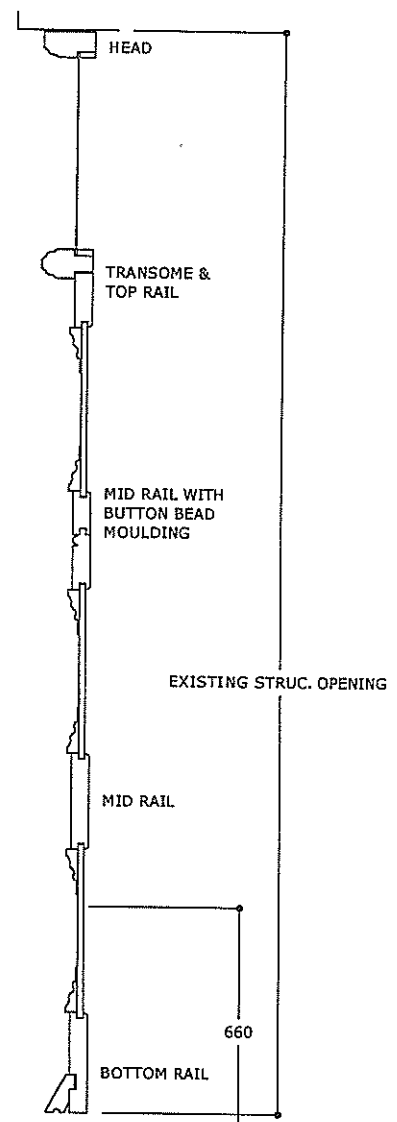

SECTION

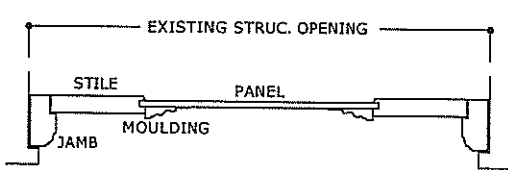

PLAN

3 PANEL DOOR
 TYPICAL ELEVATION PLAN
 & SECTION
 1/20 SCALE

Head of Planning and Economic Regeneration
 Civic Centre
 Newport
 South Wales
 Telephone 01633 232163



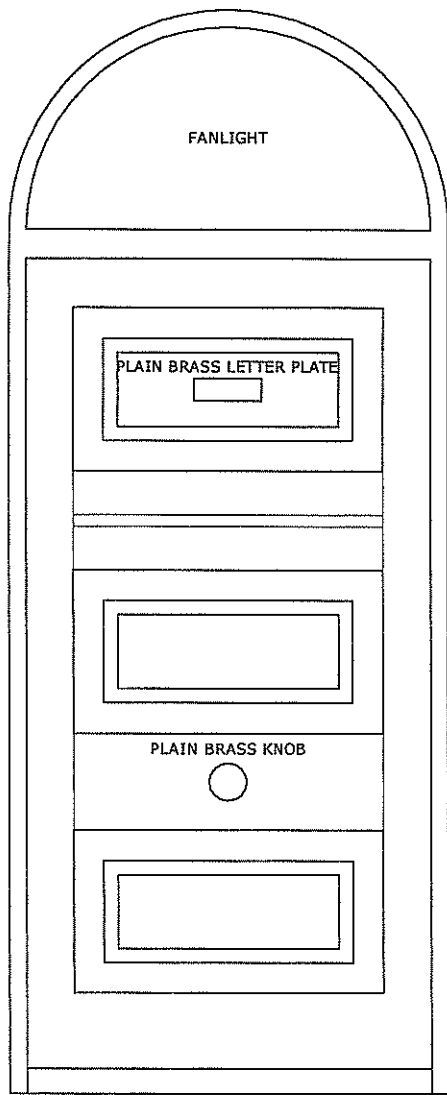

ELEVATION

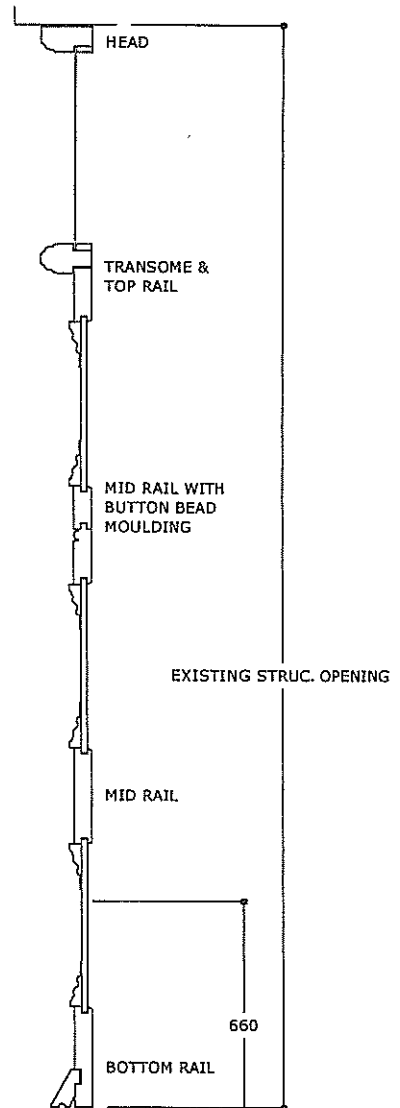

SECTION

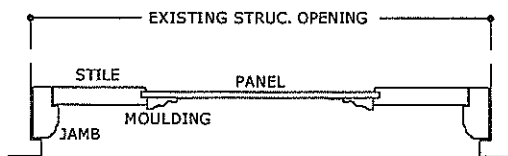

PLAN

3 PANEL DOOR
TYPICAL ELEVATION PLAN
& SECTION

1/20 SCALE

Head of Planning and Economic Regeneration

Civic Centre
Newport
South Wales

Telephone 01633 232163



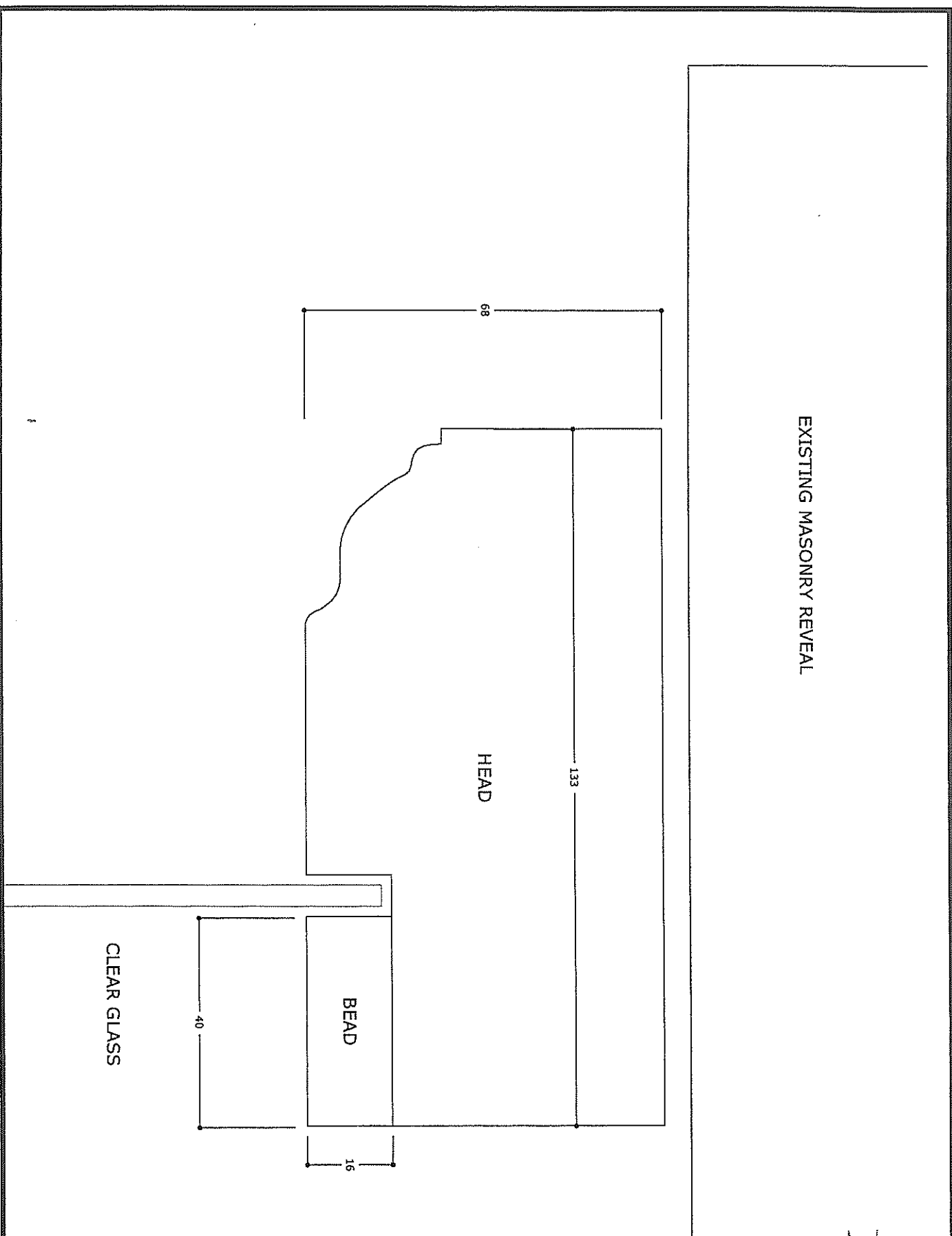

3 PANEL DOOR
TYPICAL FANLIGHT HEAD SECTION

FULL SIZE

Head of Planning and Economic Regeneration

Civic Centre
Newport
South Wales

Telephone 01633 232163



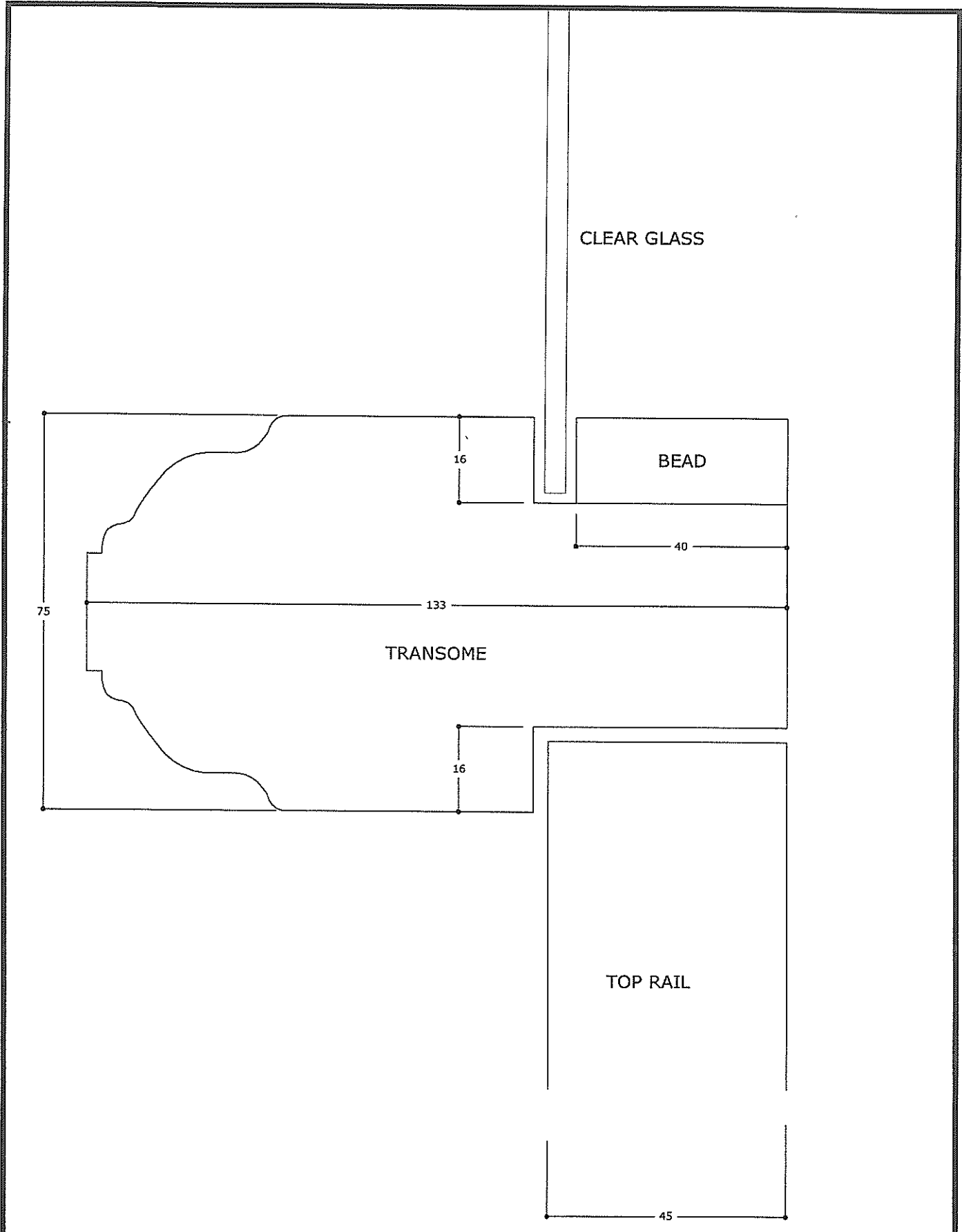

3 PANEL DOOR
 TYPICAL DOOR TRANSOME
 SECTION
 FULL SIZE

Head of Planning and Economic Regeneration
 Civic Centre
 Newport
 South Wales
 Telephone 01633 232163



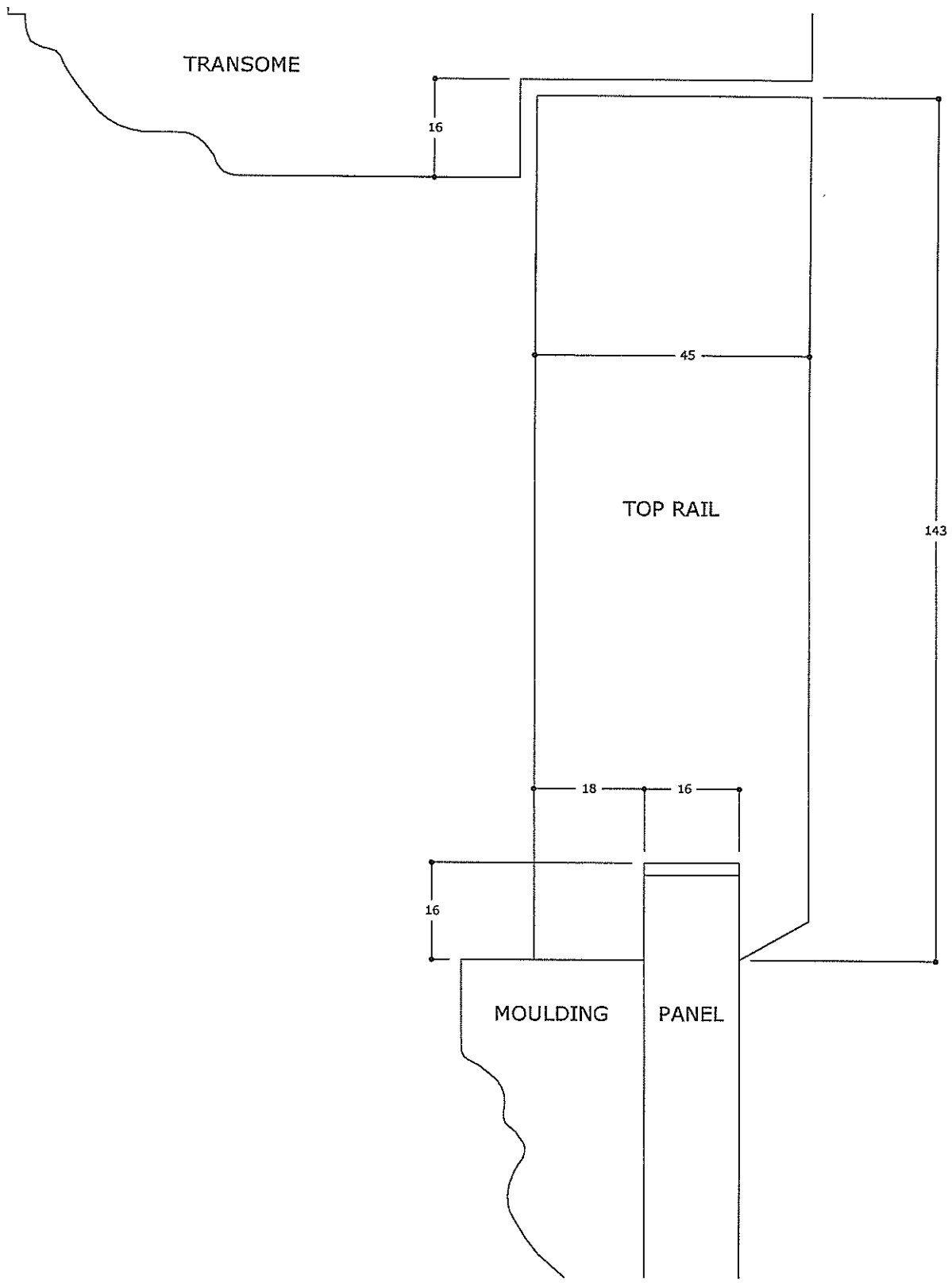

3 PANEL DOOR
 TYPICAL TOP RAIL
 SECTION
 FULL SIZE

Head of Planning and Economic Regeneration
 Civic Centre
 Newport
 South Wales
 Telephone 01633 232163



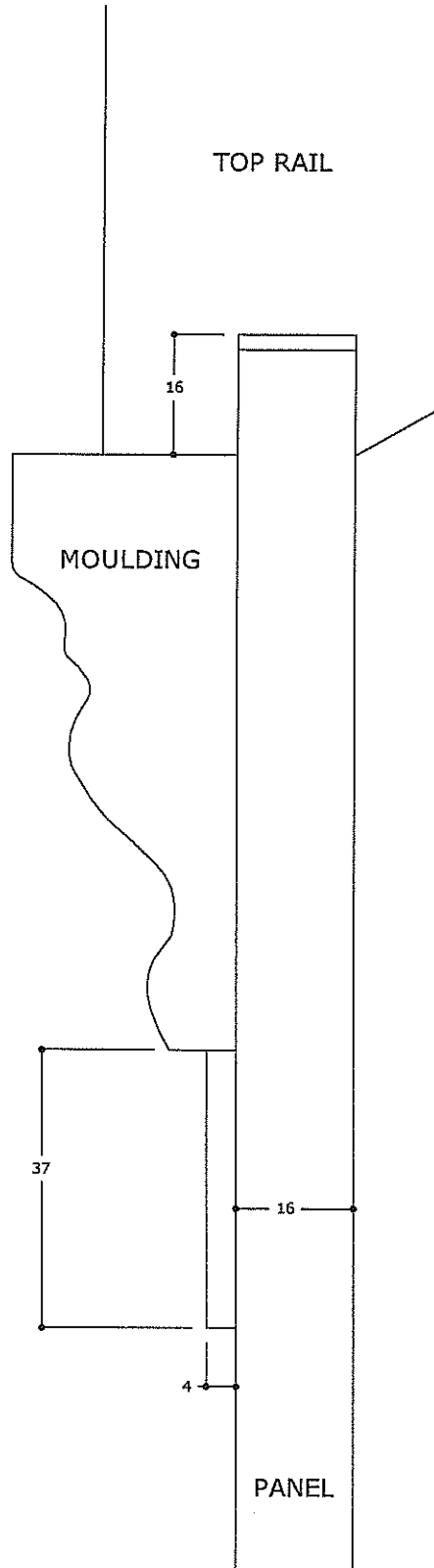

3 PANEL DOOR
 PANEL & MOULDING
 SECTION
 FULL SIZE

Head of Planning and Economic Regeneration
 Civic Centre
 Newport
 South Wales
 Telephone 01633 232163



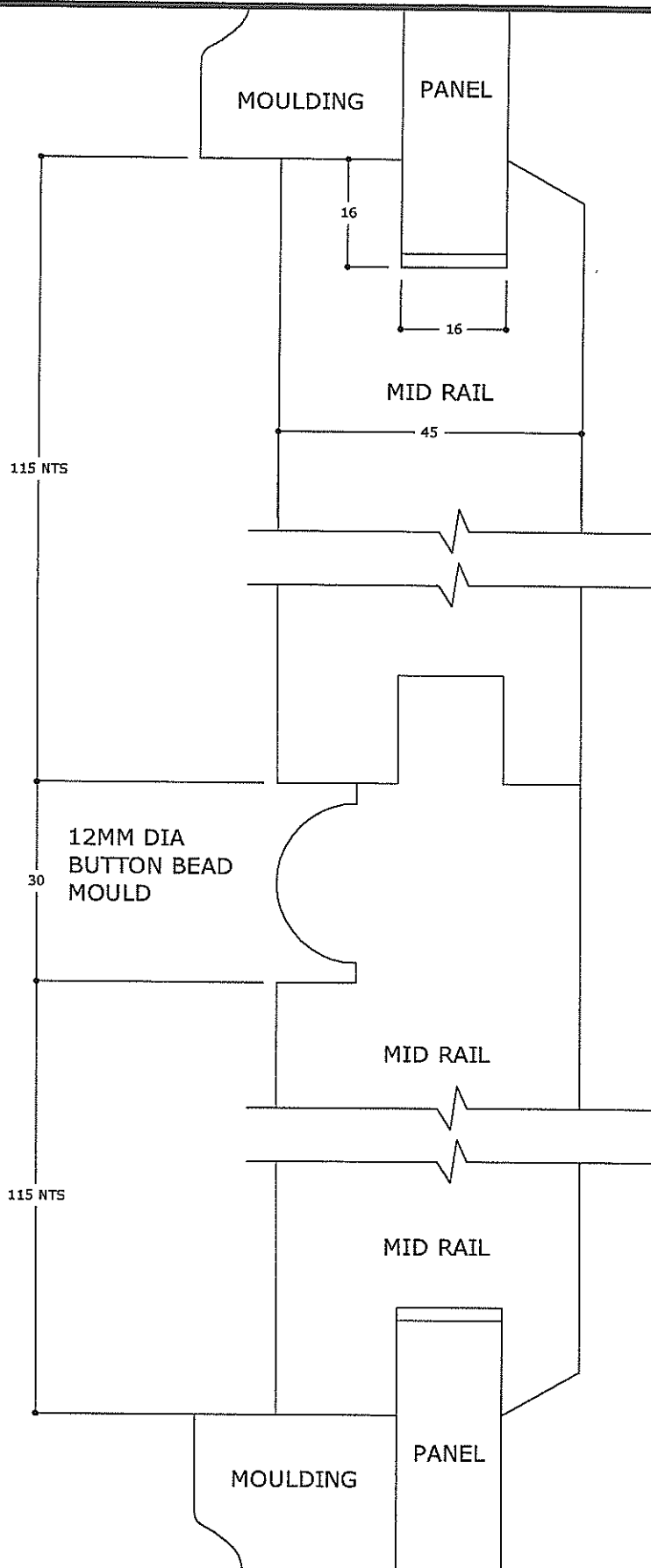

3 PANEL DOOR
TYPICAL MID RAIL
SECTION

FULL SIZE

Head of Planning and Economic Regeneration

Civic Centre
Newport
South Wales

Telephone 01633 232163



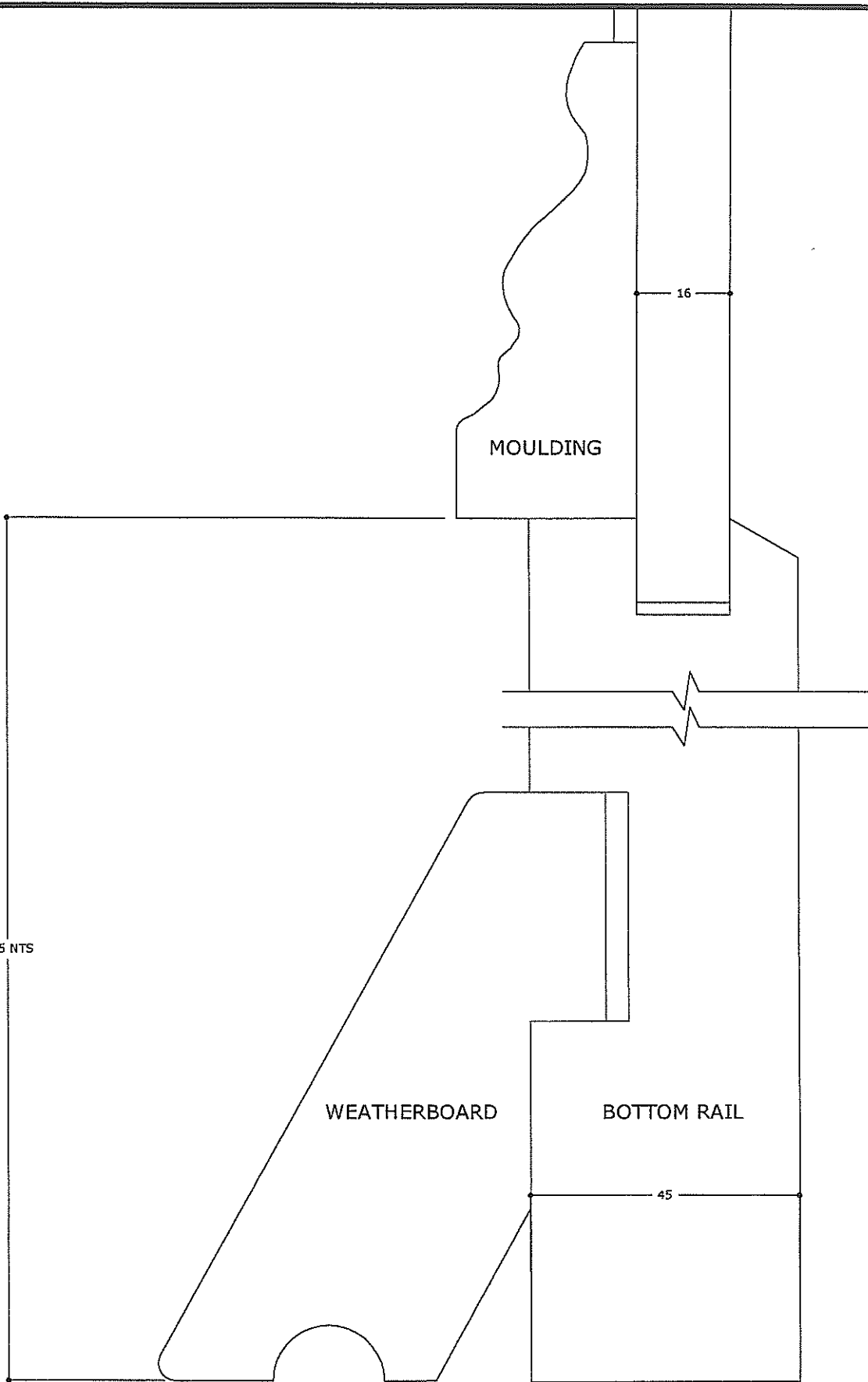

3 PANEL DOOR
 TYPICAL BOTTOM RAIL
 SECTION
 FULL SIZE

Head of Planning and Economic Regeneration
 Civic Centre
 Newport
 South Wales
 Telephone 01633 232163



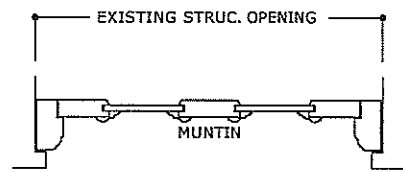
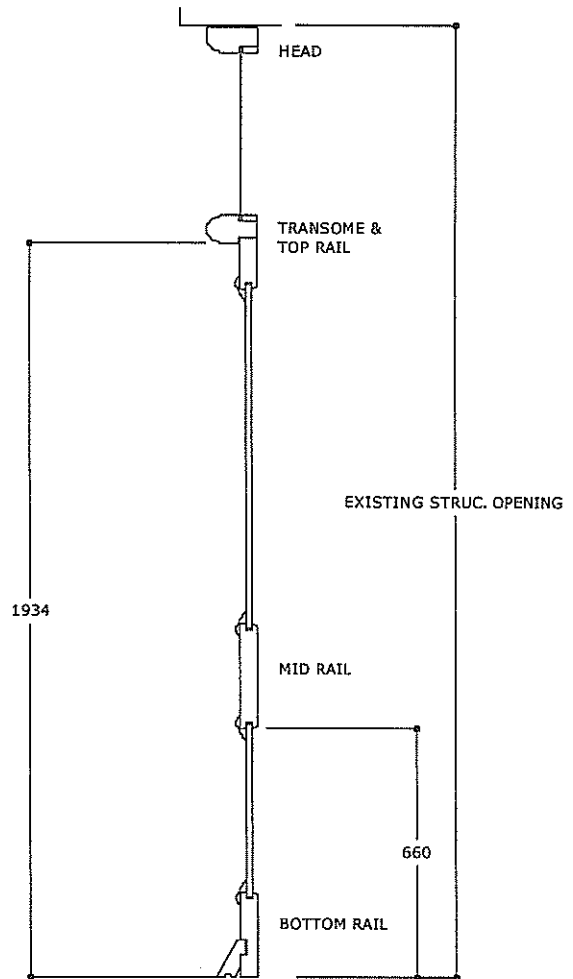
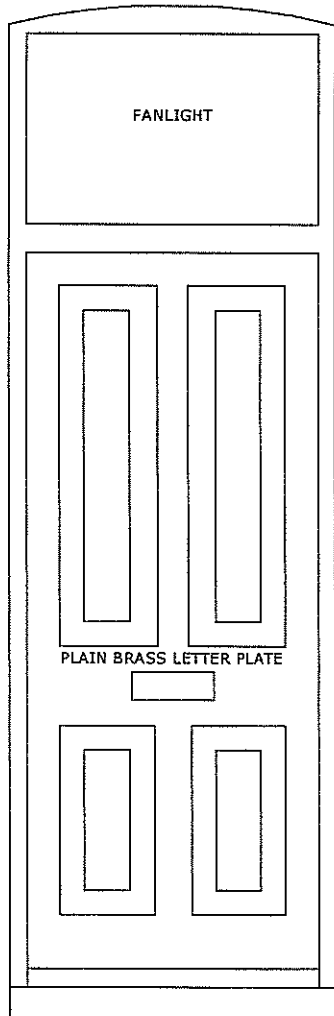

4 PANEL DOOR
 ELEVATION PLAN
 & SECTION
 1/20 SCALE

Head of Planning and Economic Regeneration
 Civic Centre
 Newport
 South Wales
 Telephone 01633 232163



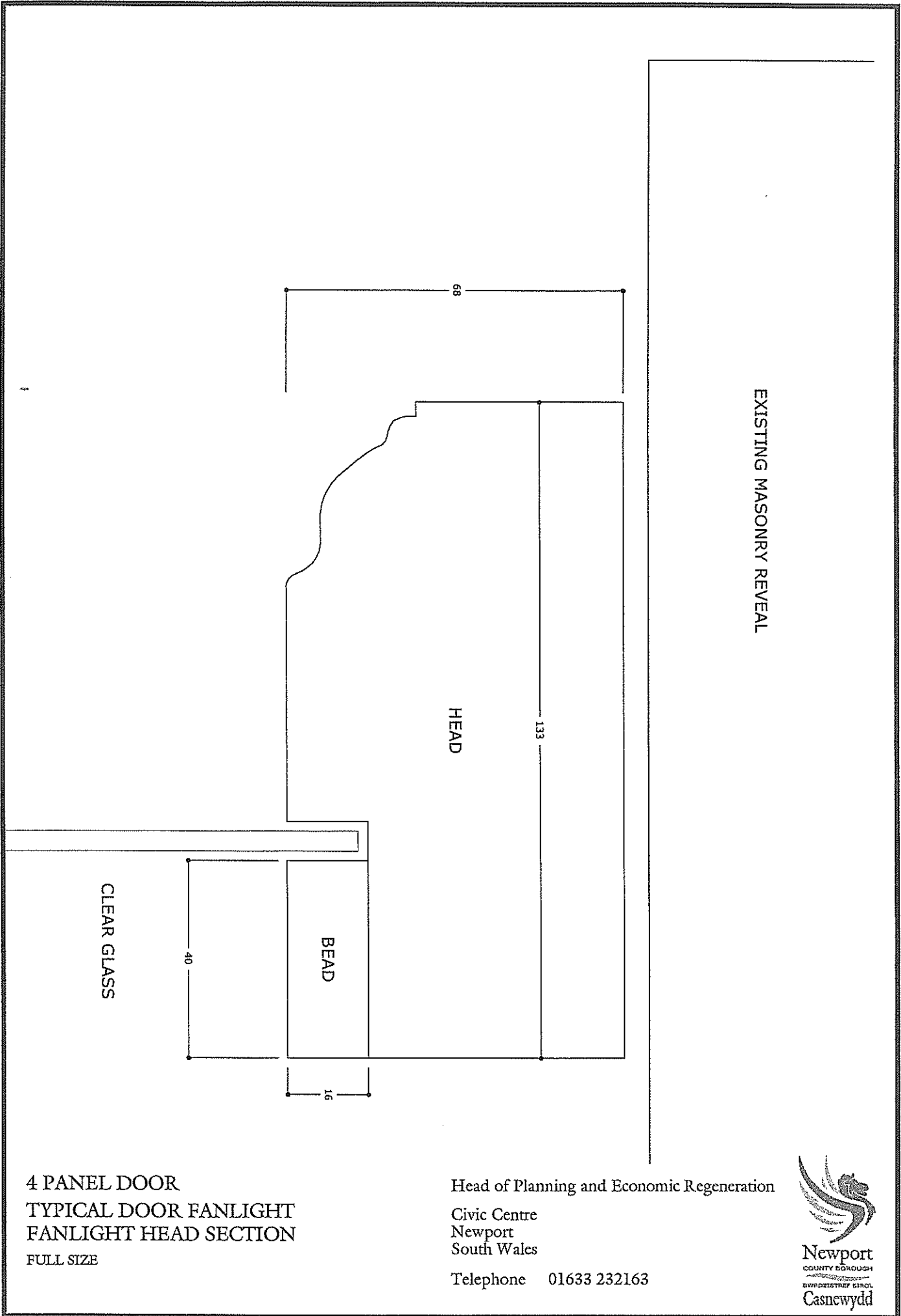

4 PANEL DOOR
 TYPICAL DOOR FANLIGHT
 FANLIGHT HEAD SECTION
 FULL SIZE

Head of Planning and Economic Regeneration
 Civic Centre
 Newport
 South Wales
 Telephone 01633 232163



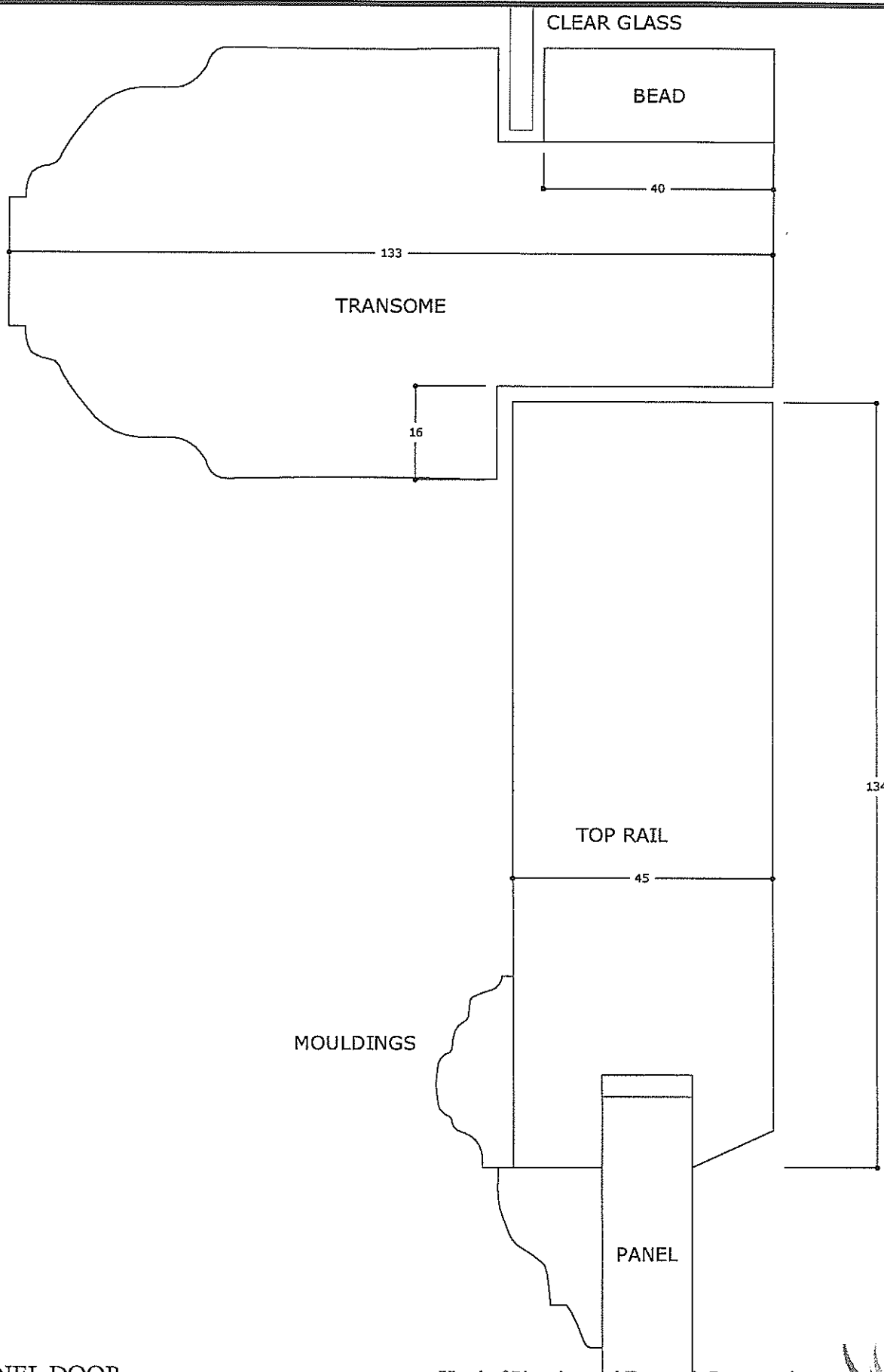

4 PANEL DOOR
 TYPICAL DOOR TOP RAIL & TRANSOME
 SECTION
 FULL SIZE

Head of Planning and Economic Regeneration
 Civic Centre
 Newport
 South Wales
 Telephone 01633 232163



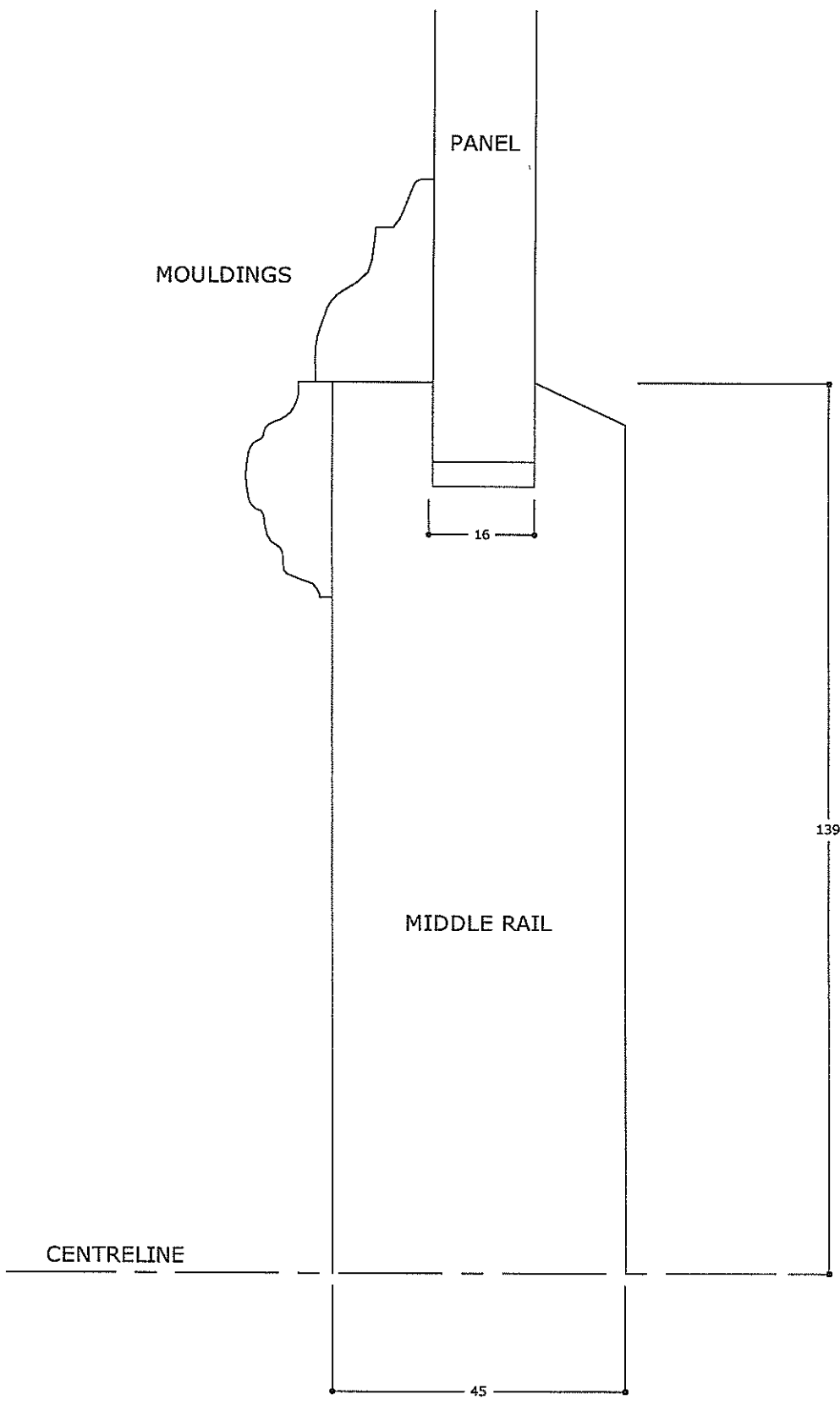

4 PANEL DOOR
 TYPICAL DOOR MIDDLE RAIL
 HALF SECTION
 FULL SIZE

Head of Planning and Economic Regeneration
 Civic Centre
 Newport
 South Wales
 Telephone 01633 232163



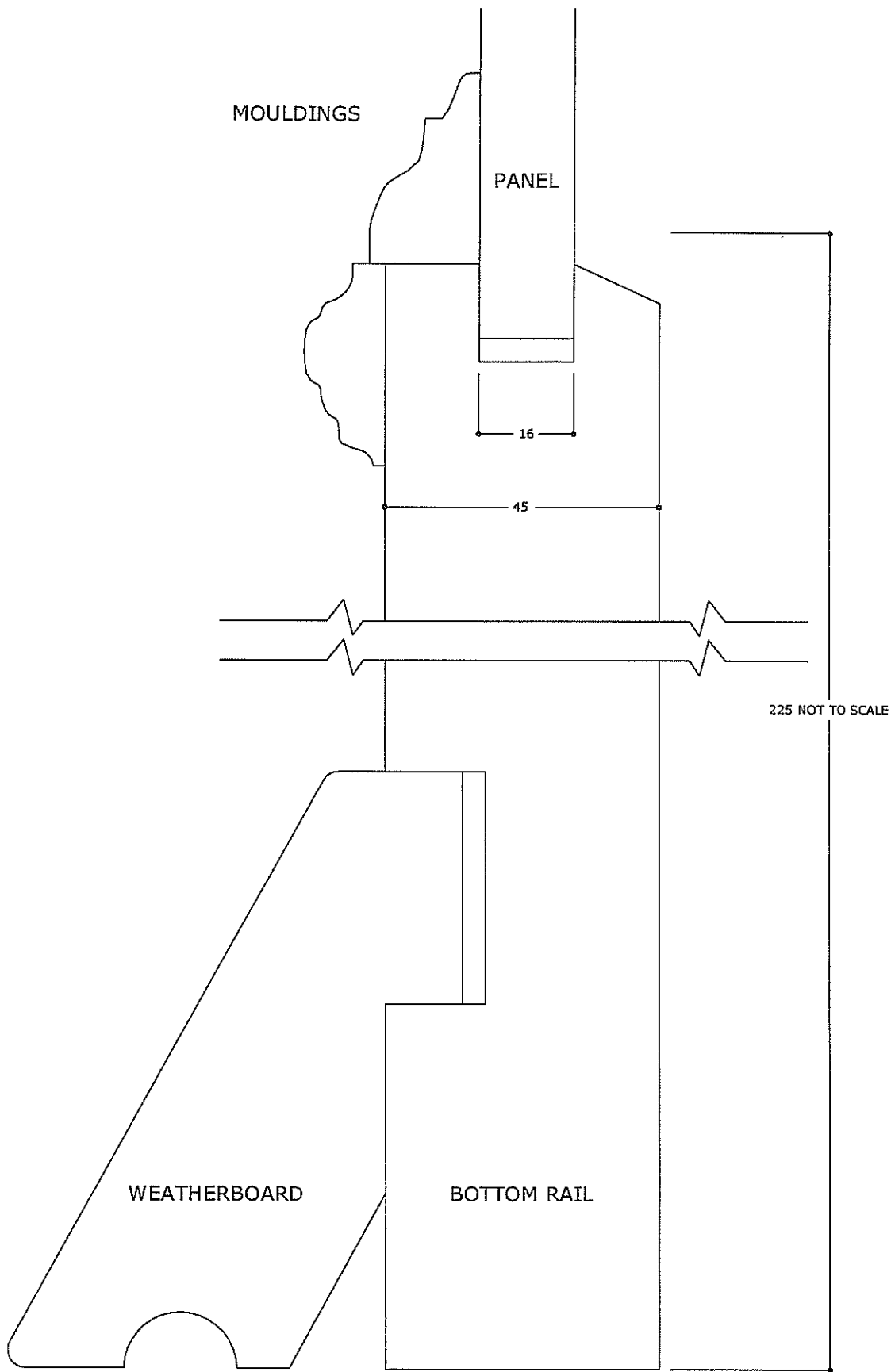

4 PANEL DOOR
TYPICAL DOOR BOTTOM RAIL

FULL SIZE

Head of Planning and Economic Regeneration

Civic Centre
Newport
South Wales

Telephone 01633 232163



Newport
COUNTY BOROUGH
BWADEISTREF SIROL
Casnewydd

EXISTING
MASONRY
REVEAL

45

JAMB

TO SUIT REVEAL

16

STILE

45

127

MOULDING

MOULDING

PANEL

16

4 PANEL DOOR
TYPICAL JAMB & STILE SECTION

FULL SIZE

Head of Planning and Economic Regeneration

Civic Centre
Newport
South Wales

Telephone 01633 232163



Newport
COUNTY BOROUGH
BURDSEMER DIACL
Casnewydd

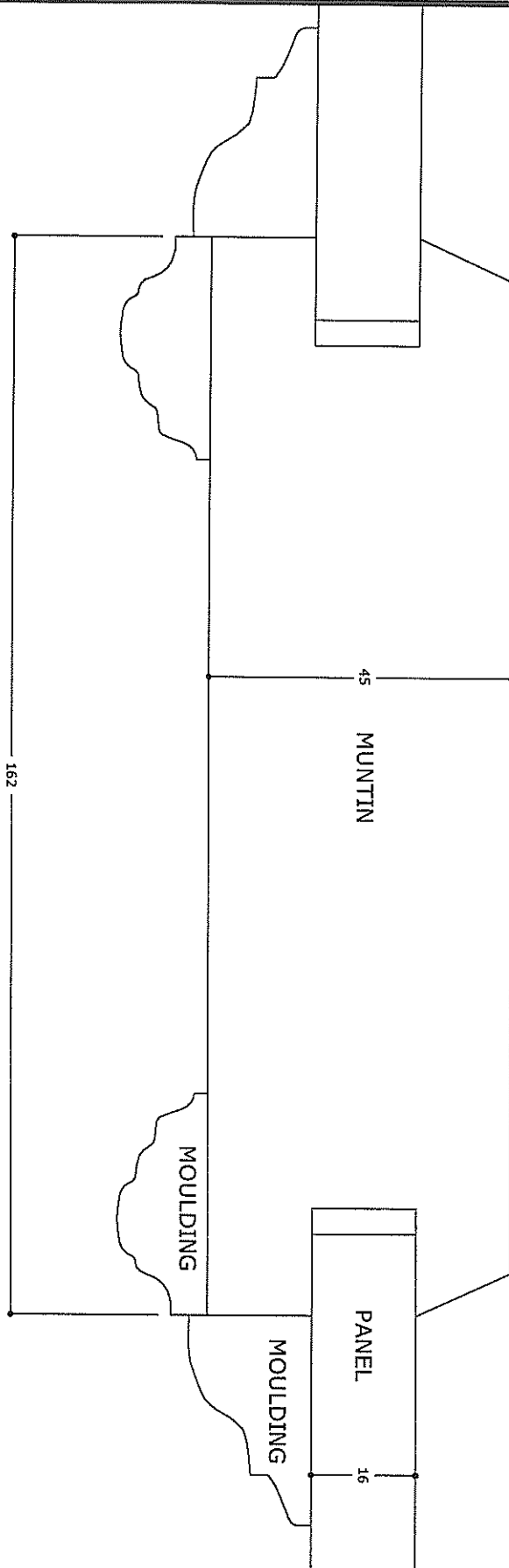

4 PANEL DOOR
TYPICAL MUNTIN SECTION

FULL SIZE

Head of Planning and Economic Regeneration

Civic Centre
Newport
South Wales

Telephone 01633 232163



Newport
COUNTY BOROUGH
DYWYDREIY SIRIOL
Casnewydd



WHERE EXISTING BRICKWORK
REMAINS:
REPOINT & RESTORE

WHERE BRICKWORK HAS
PREVIOUSLY BEEN RENDERED:
HACK OFF & APPLY SMOOTH
CEMENT RENDER WITH WOOD
FLOAT FINISH

4 PANEL DOOR

25MM DEEP X 300MM (APPROX) HIGH CEMENT RENDER PLINTH

2 OVER 2
OR 4 OVER
4 SASH WINDOWS

DOLPHIN STREET
TYPICAL ELEVATION

1/50 SCALE

Head of Planning and Economic Regeneration

Civic Centre
Newport
South Wales

Telephone 01633 232163





SOUTH MARKET STREET
TYPICAL ELEVATION

FULL SIZE

Head of Planning and Economic Regeneration

Civic Centre
Newport
South Wales

Telephone 01633 232163

